



VERSOS

Plug-in Walkthrough

Unreal Engine



Window

- Cinematics
- Content Browser
- Details
- ImgMedia
- Outliner
- Viewports
- World Partition
- Env. Light Mixer
- Hierarchical LOD Outliner
- Layers
- Levels
- Light Mixer
- Place Actors
- Variant Manager
- World Settings
- LOG
 - Device Output Log
 - Message Log
 - Output Log
- GET CONTENT
 - Open Marketplace
 - Quixel Bridge
- LAYOUT
 - Load Layout
 - Save Layout
 - Remove Layout
- Enable Fullscreen (SHIFT+F11)
- Versos Plugin**



**To open application:
Window > Versos Plug-in**

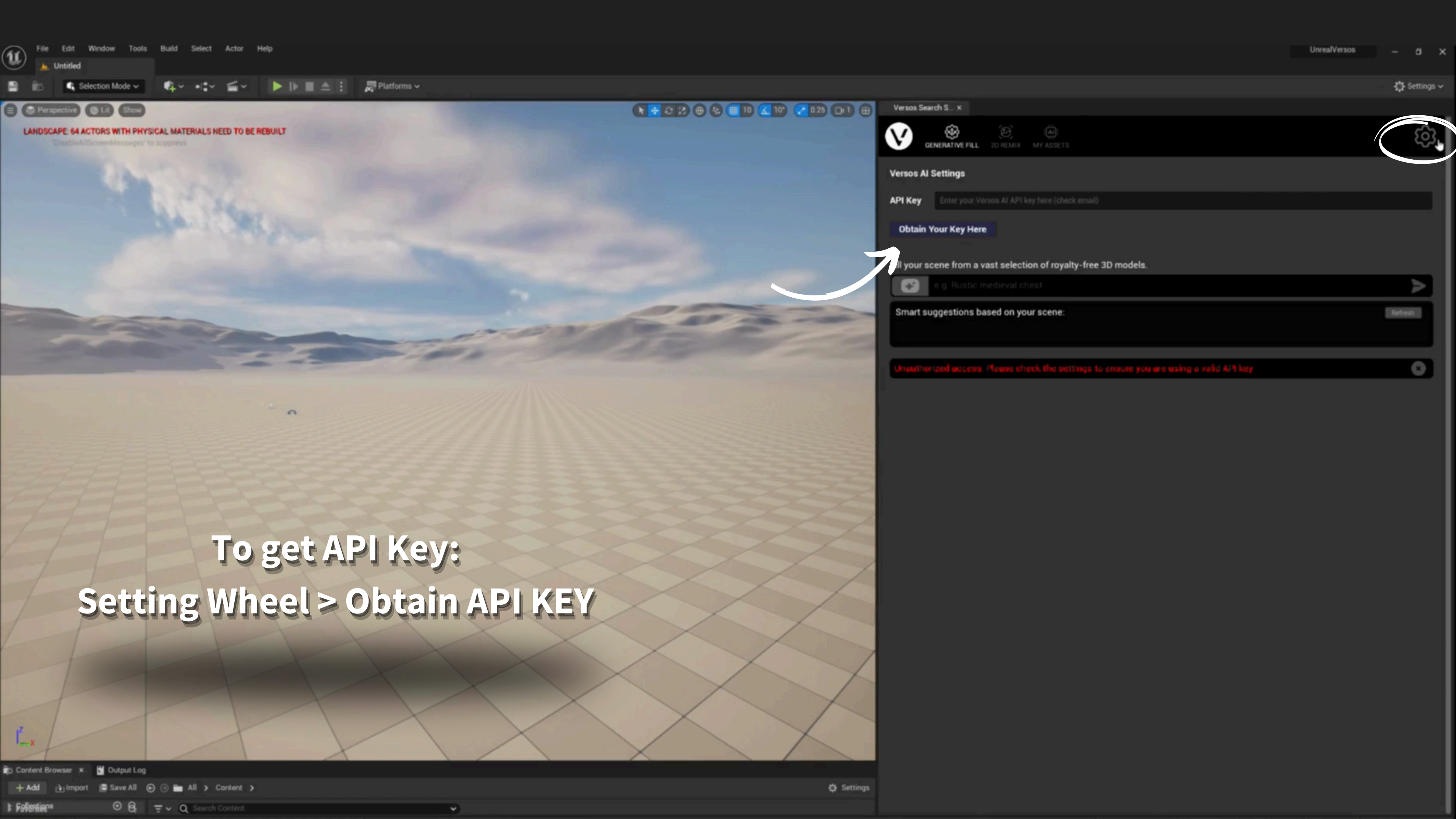

**To get API Key:
Setting Wheel > Obtain API KEY**



Create your account

Welcome! Please fill in the details to get started.

First name Optional Last name Optional

Email address

Password

Continue >

Already have an account? [Sign in](#)

You will be redirected
to our website,
VERSOS.AI, to sign up.

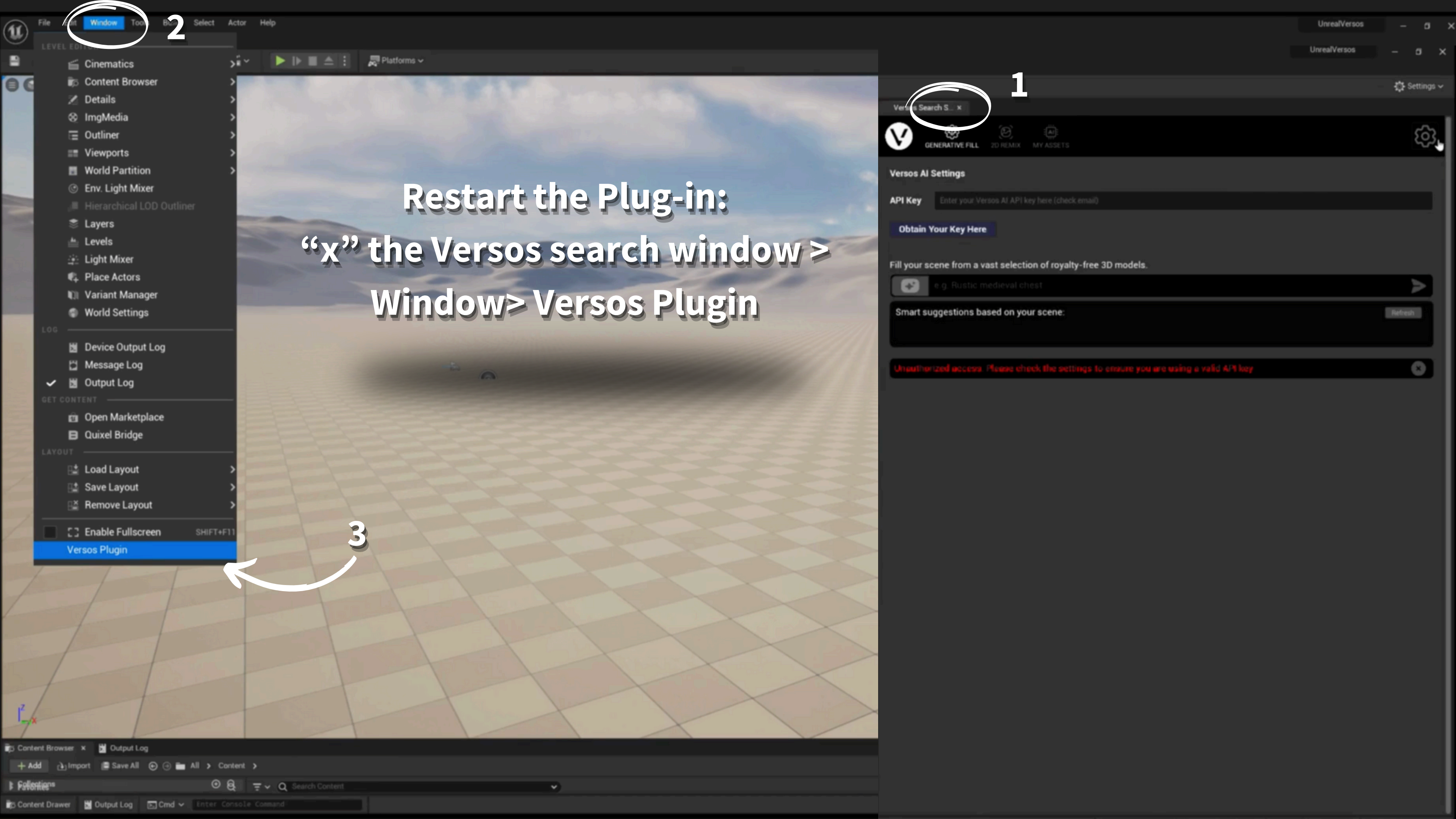



Restart the Plug-in:
"x" the Versos search window >
Window > Versos Plugin

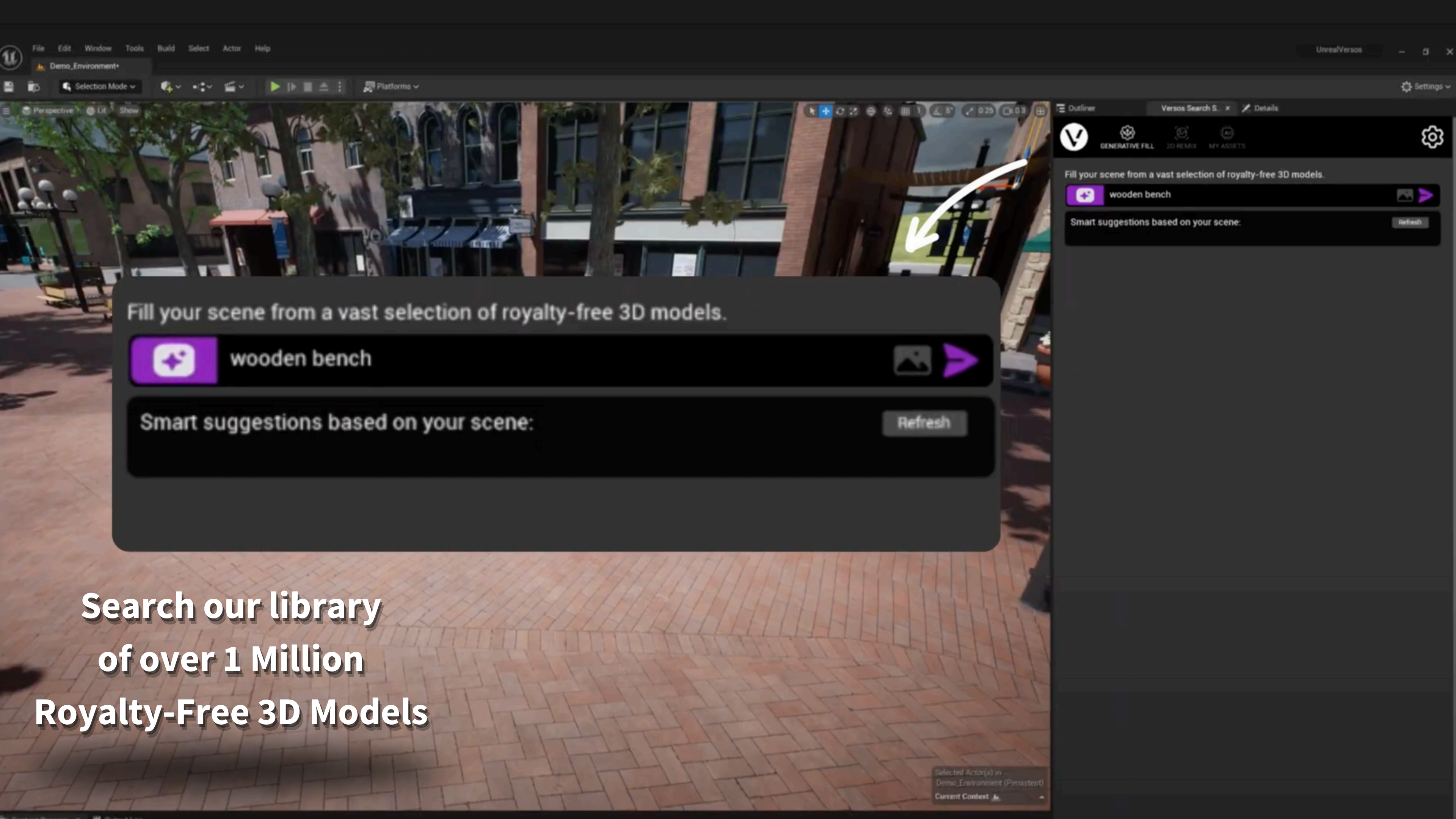



Fill your scene from a vast selection of royalty-free 3D models.

 wooden bench  

Smart suggestions based on your scene: 

**Search our library
of over 1 Million
Royalty-Free 3D Models**

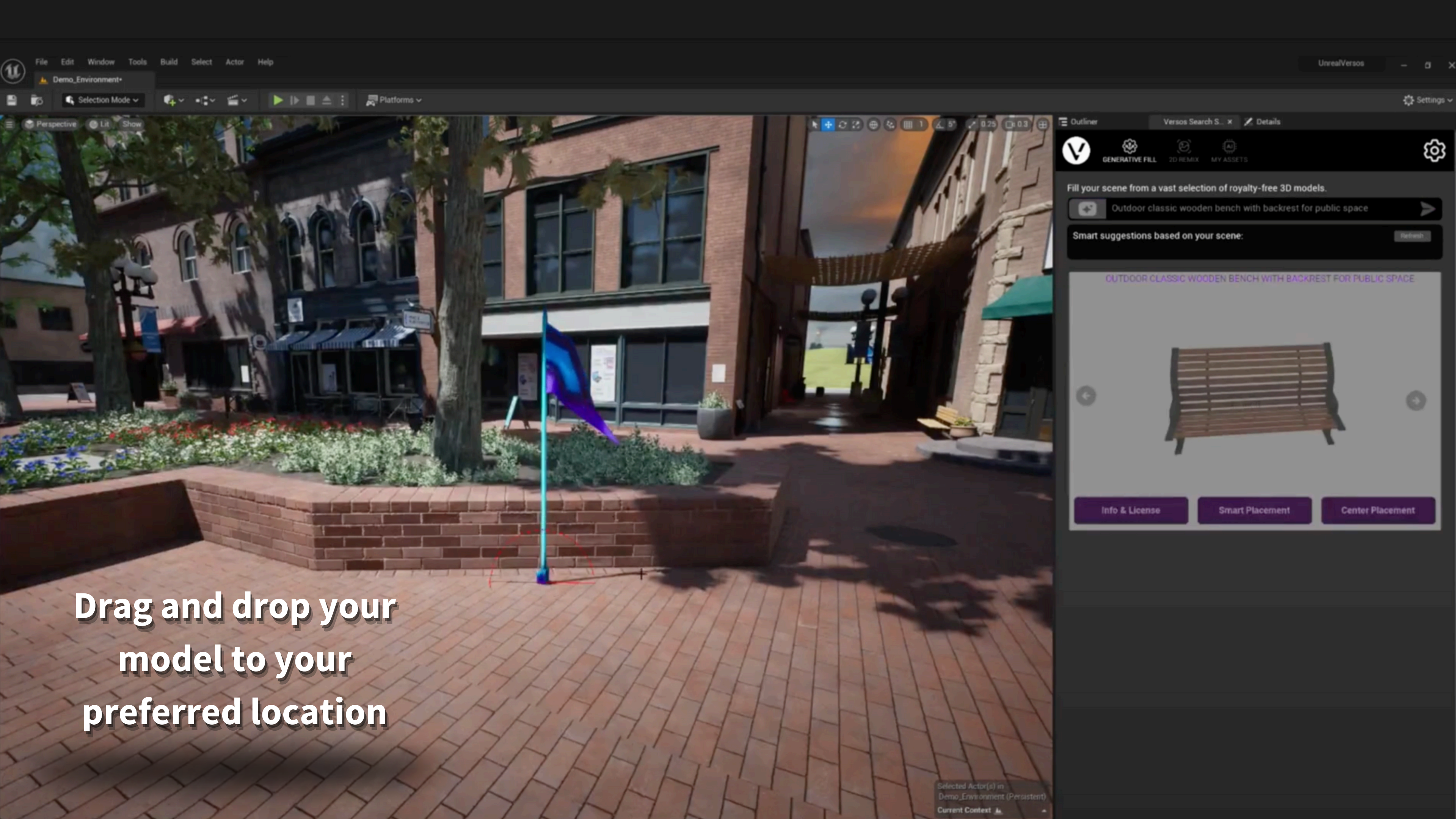

Drag and drop your model to your preferred location

Outliner Versos Search S... Details

GENERATIVE FILL 2D REMIX MY ASSETS

Fill your scene from a vast selection of royalty-free 3D models.

Outdoor classic wooden bench with backrest for public space

Smart suggestions based on your scene: Refresh

OUTDOOR CLASSIC WOODEN BENCH WITH BACKREST FOR PUBLIC SPACE

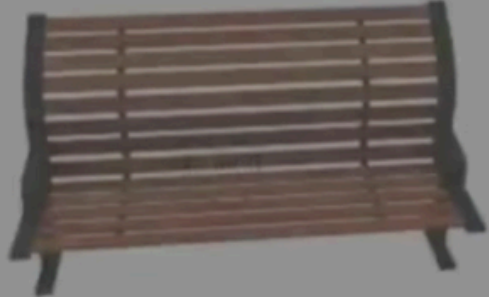

Info & License Smart Placement Center Placement

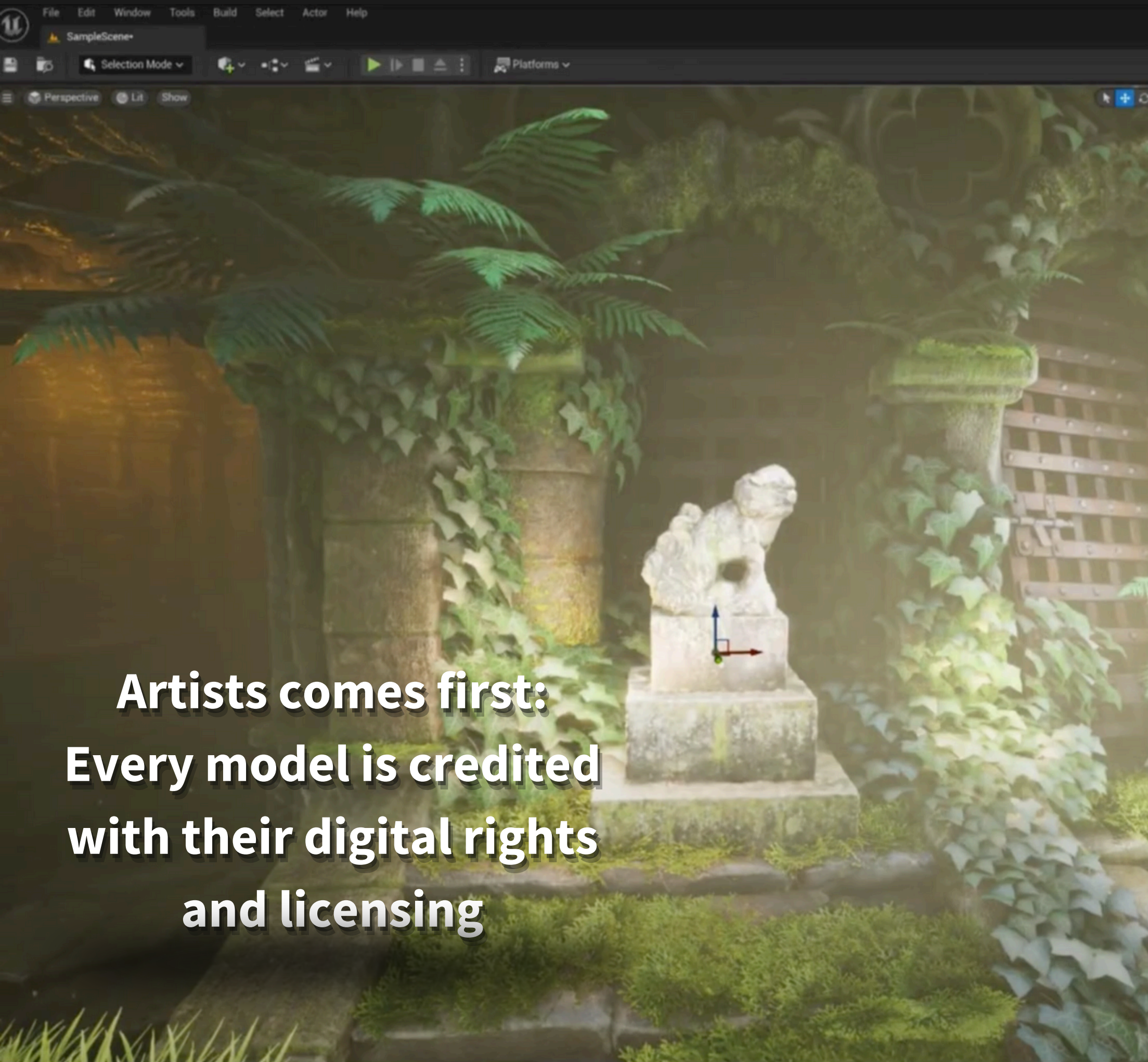

**Artists comes first:
Every model is credited
with their digital rights
and licensing**



Fill your scene from a vast selection of royalty-free 3D models.

 stone pedestal with moss 

Smart suggestions based on your scene:



Profile URL <https://sketchfab.com/tragao0196>
Face Count **55045**
Asset License Attribution 4.0 International

Creative Commons Corporation ("Creative Commons") is not a law firm and does not provide legal services or legal advice. Distribution of Creative Commons public licenses does not create a lawyer-client or other relationship. Creative Commons makes its licenses and related information available on an "as-is" basis. Creative Commons gives no warranties regarding its licenses, any material licensed under their terms and conditions, or any related information. Creative Commons disclaims all liability for damages resulting from their use to the fullest extent possible.

Using Creative Commons Public Licenses



Creative Commons public licenses provide a standard set of terms and conditions that creators and other rights holders may use to share original works of authorship and other material subject to copyright and certain other rights specified in the public license below. The following considerations are for informational purposes only, are not exhaustive, and do not form part of our licenses.

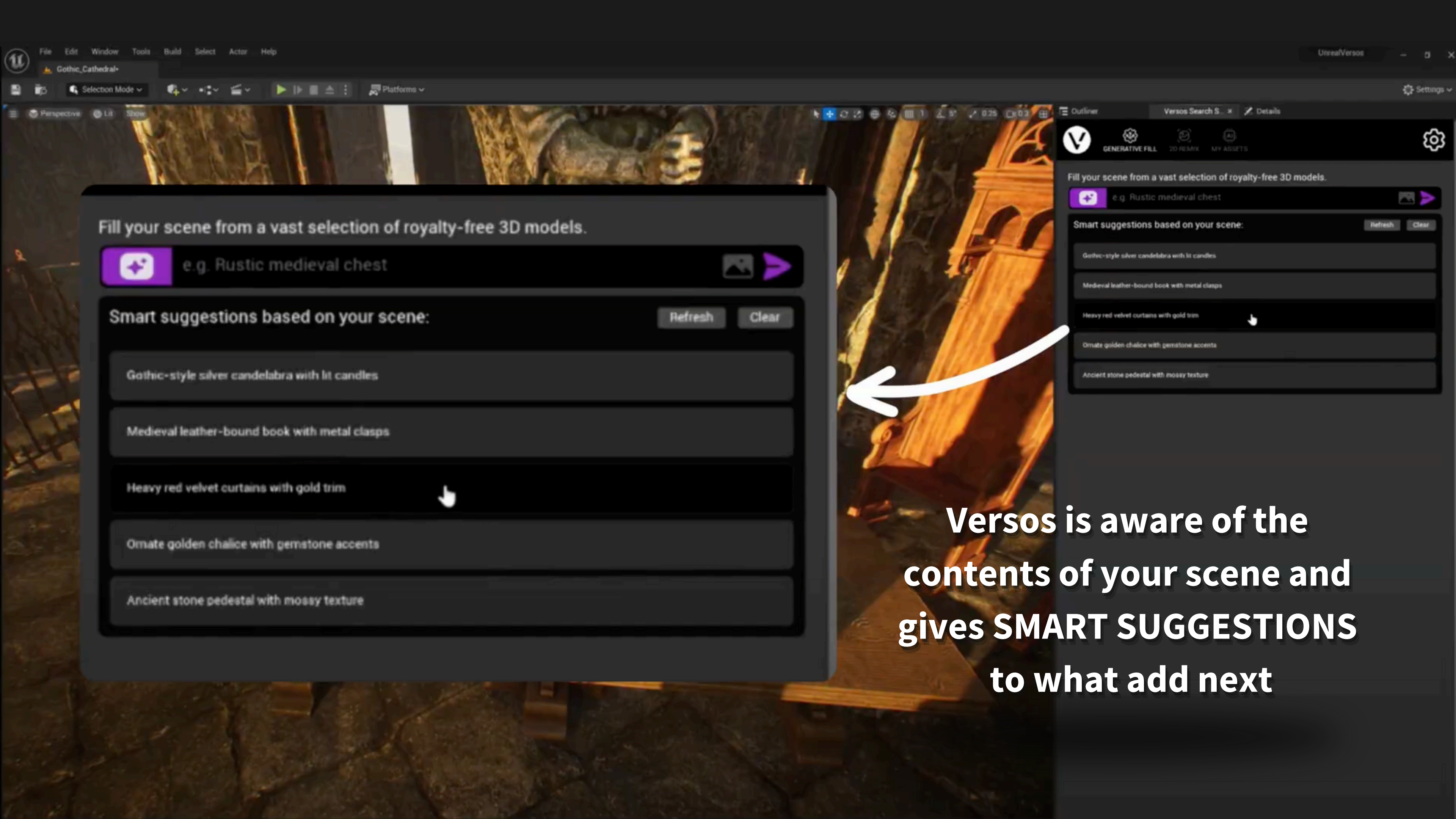

Considerations for licensors: Our public licenses are intended for use by those authorized to give the public permission to use material in ways otherwise restricted by copyright and certain other rights. Our licenses are irrevocable. Licensors should read and understand the terms and conditions of the license they choose before applying it. Licensors should also secure all rights necessary before applying our licenses so that the public can reuse the material as expected. Licensors should clearly mark any material not subject to the license. This includes other CC-licensed material, or material used under an exception or limitation to copyright. More considerations for licensors: wiki.creativecommons.org/Considerations_for_licensors

Considerations for the public: By using one of our public licenses, a licensor grants the public permission to use the licensed material under specified terms and conditions. If

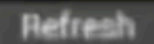

Fill your scene from a vast selection of royalty-free 3D models.

 e.g. Rustic medieval chest  

Smart suggestions based on your scene:  

- Gothic-style silver candelabra with lit candles
- Medieval leather-bound book with metal clasps
- Heavy red velvet curtains with gold trim
- Ornate golden chalice with gemstone accents
- Ancient stone pedestal with mossy texture

Versos is aware of the contents of your scene and gives SMART SUGGESTIONS to what add next

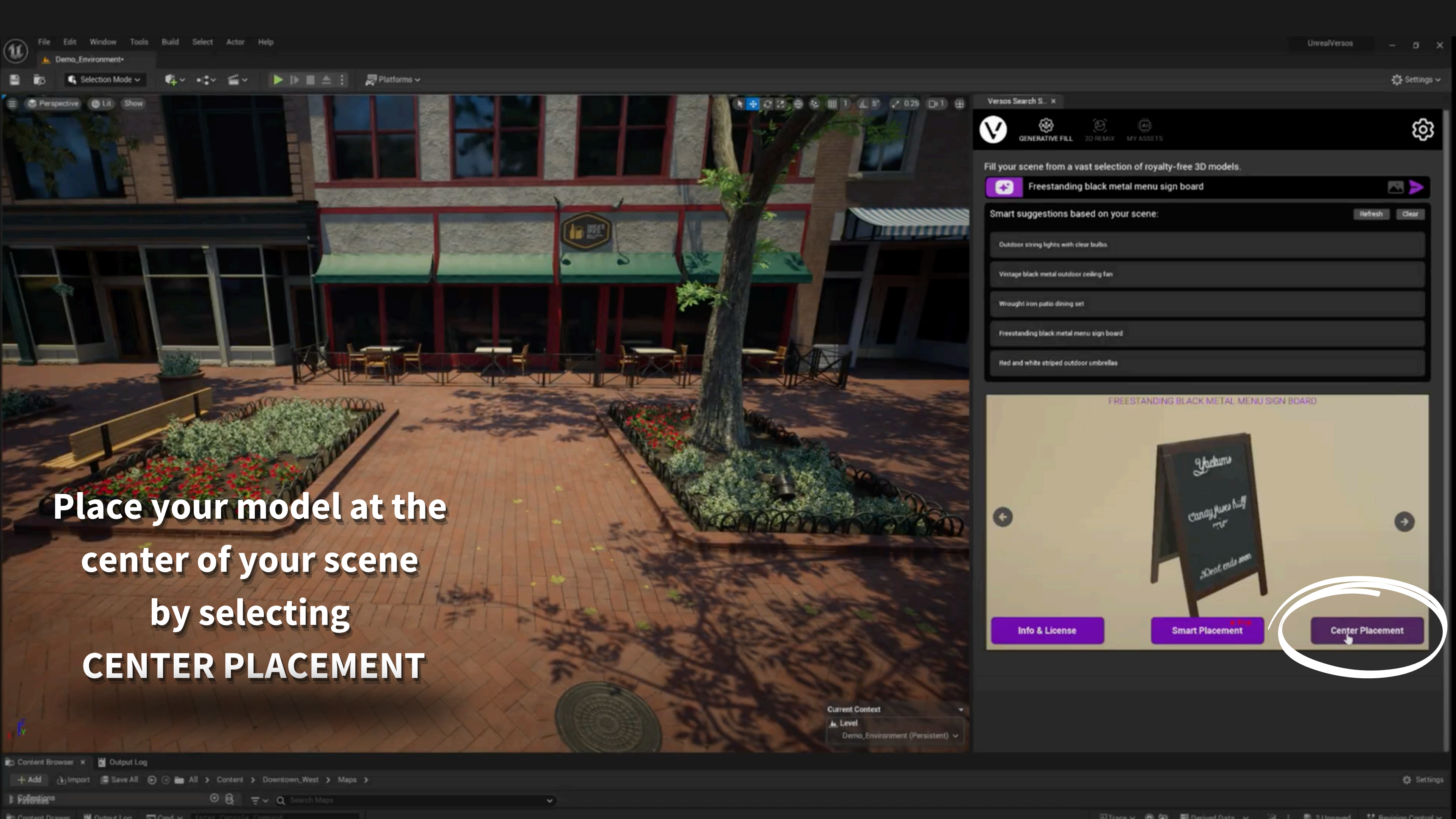

Place your model at the center of your scene by selecting **CENTER PLACEMENT**

Versos Search S...

GENERATIVE FILL 2D REMIX MY ASSETS

Fill your scene from a vast selection of royalty-free 3D models.

Freestanding black metal menu sign board

Smart suggestions based on your scene: Refresh Clear

- Outdoor string lights with clear bulbs
- Vintage black metal outdoor ceiling fan
- Wrought iron patio dining set
- Freestanding black metal menu sign board
- Red and white striped outdoor umbrellas

FREESTANDING BLACK METAL MENU SIGN BOARD

Info & License Smart Placement **Center Placement**

Current Context
Level
Demo_Environment (Persistent)

SMART PLACEMENT
will place your asset where
it makes the most sense
aesthetically and spatially

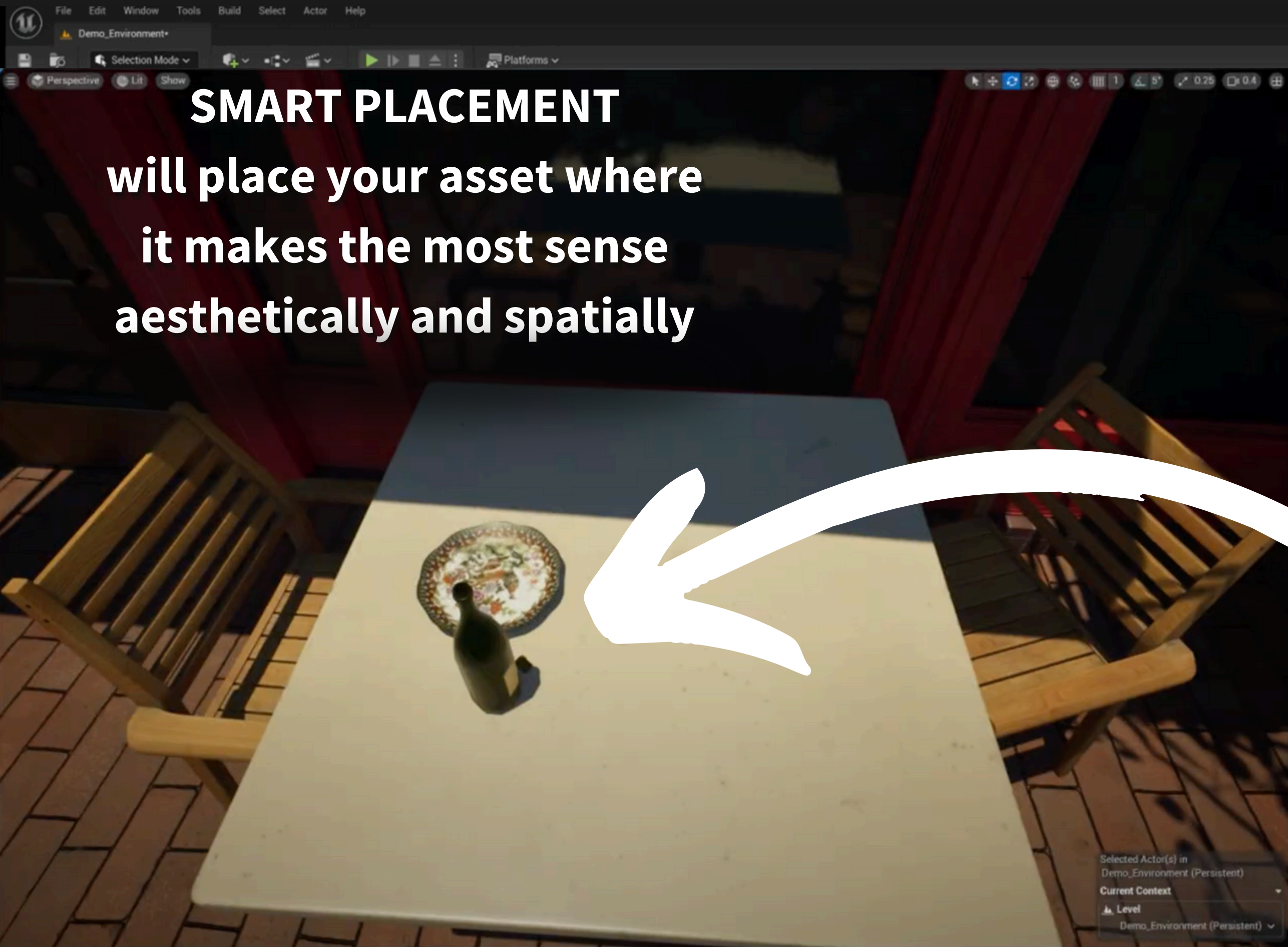

Versos Search S... x

GENERATIVE FILL 2D REMIX MY ASSETS

Fill your scene from a vast selection of royalty-free 3D models.

wine bottle

Smart suggestions based on your scene: Refresh Clear

- Outdoor patio string lights with clear bulbs
- Red and white patterned tablecloth for square table
- Large green potted plant for patio corner
- Black metal outdoor wall sconce beside door
- Decorative ceramic plate set on table

WINE BOTTLE

Info & License Smart Placement Center Placement

The image shows the 'Versos Search' interface within Unreal Engine. It features a search bar with 'wine bottle' entered. Below the search bar, there are 'Smart suggestions based on your scene' which include items like 'Outdoor patio string lights with clear bulbs', 'Red and white patterned tablecloth for square table', 'Large green potted plant for patio corner', 'Black metal outdoor wall sconce beside door', and 'Decorative ceramic plate set on table'. A 'Smart Placement' button is highlighted with a white circle, and a white arrow points from this button towards the wine bottle in the demo environment. The interface also includes 'Info & License' and 'Center Placement' buttons.

Versos will enhance your search by using Large Language Model to find assets that best fit your scene

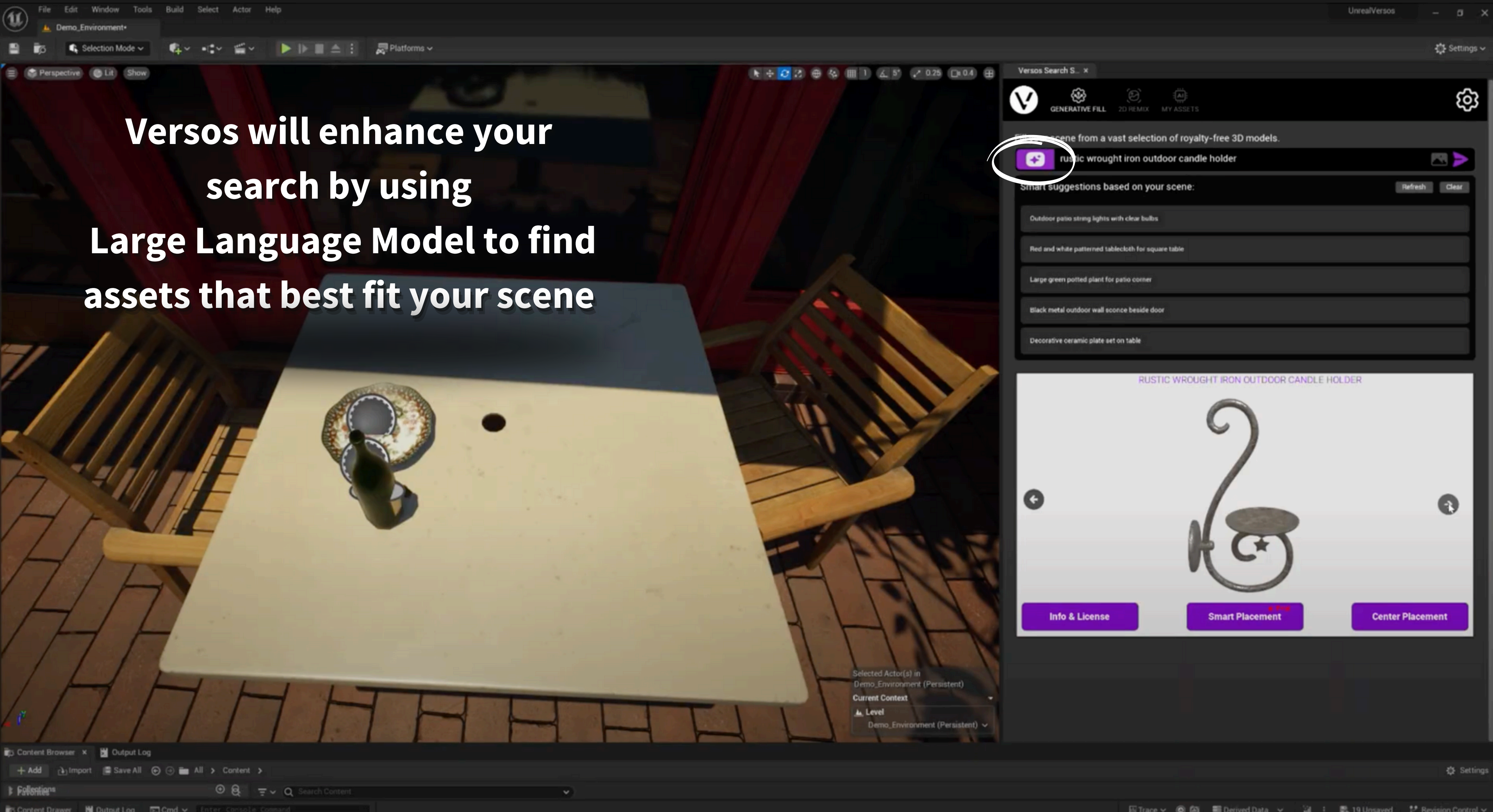

Ungroup multiple mesh assets to move and/or delete unwanted meshes.

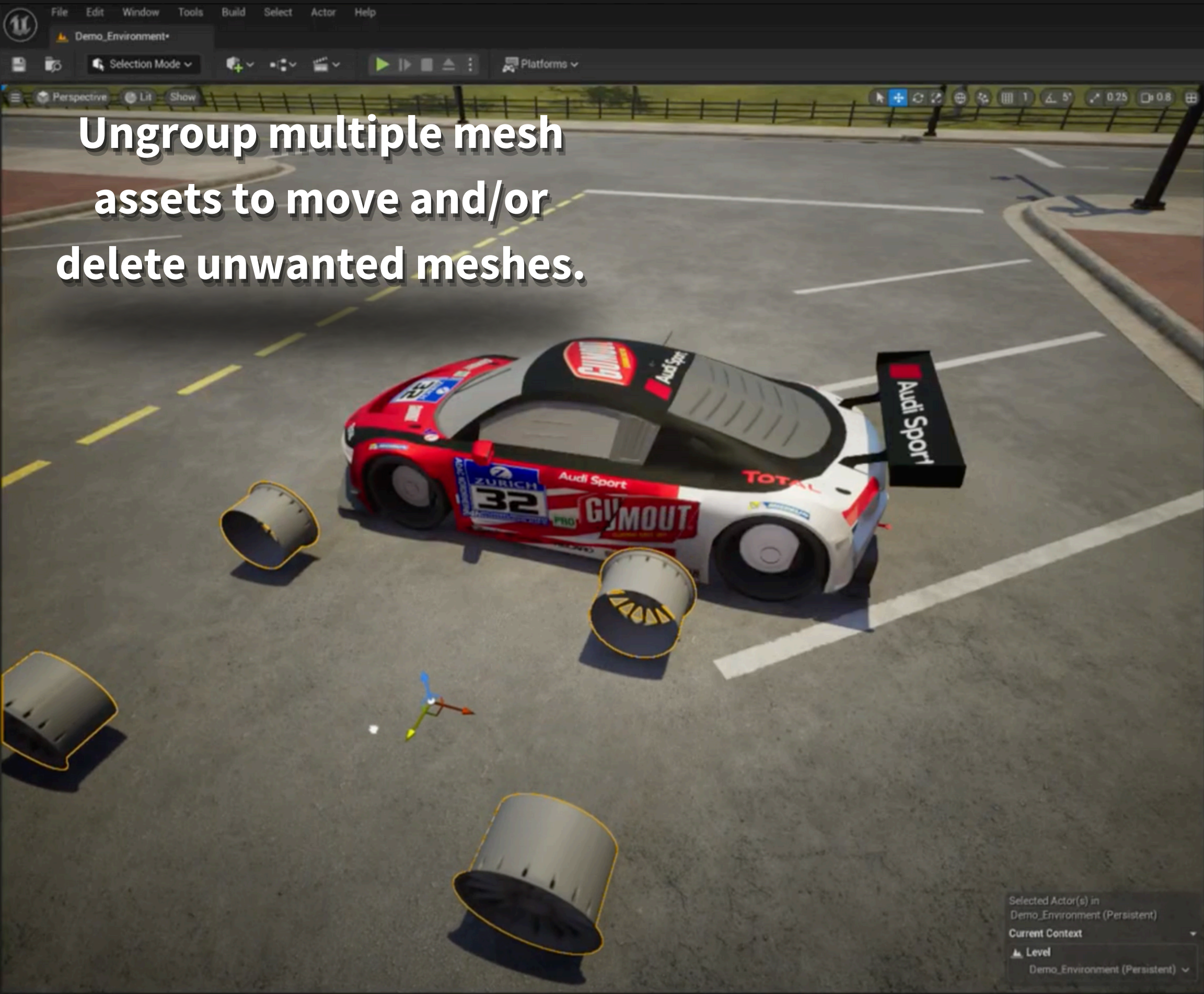

Outliner

VersosImporter5

VersosImporter5 (Self)

DefaultSceneRoot

Search

General Actor Misc Streaming All

Child Actors 14 Array elements

Index [0]	StaticMeshActor 43		
Index [1]	StaticMeshActor 44		
Index [2]	StaticMeshActor 45		
Index [3]	StaticMeshActor 46		
Index [4]	StaticMeshActor 47		
Index [5]	StaticMeshActor 48		
Index [6]	StaticMeshActor 49		
Index [7]	StaticMeshActor 50		
Index [8]	StaticMeshActor 51		
Index [9]	StaticMeshActor 52		
Index [10]	StaticMeshActor 53		
Index [11]	StaticMeshActor 54		
Index [12]	StaticMeshActor 55		
Index [13]	StaticMeshActor 56		

Search Result 5 Array elements

Index [0]	["id": "1689448673566.jpeg", "message": {"URL": "https://huggingface.co/datasets/allenai/objaverse/resol..."}]
Index [1]	["id": "1689418622539.jpeg", "message": {"URL": "https://huggingface.co/datasets/allenai/objaverse/resol..."}]
Index [2]	["id": "1689430937581.jpeg", "message": {"URL": "https://huggingface.co/datasets/allenai/objaverse/resol..."}]
Index [3]	["id": "1689417553335.jpeg", "message": {"URL": "https://huggingface.co/datasets/allenai/objaverse/resol..."}]
Index [4]	["id": "1689448433636.jpeg", "message": {"URL": "https://huggingface.co/datasets/allenai/objaverse/resol..."}]

Versos Imports Dir

Original Location

Bounds

Versos

Focus on Parent

File Name

Rendering

Actor Hidden In Game

Editor Billboard Scale

Replication

Net Load on Client

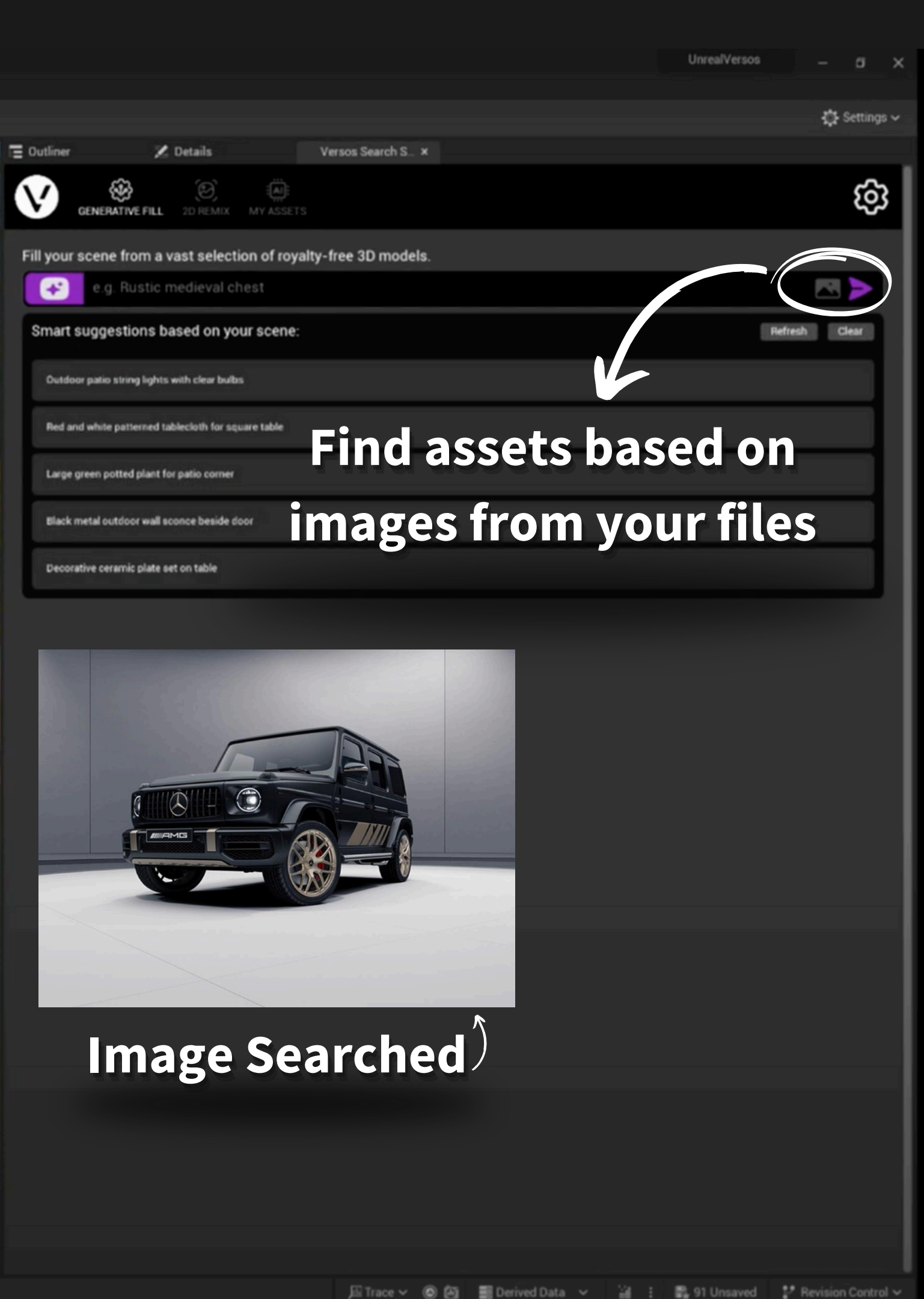

Find assets based on images from your files

Image Searched

VERSOS

**For more
information go to:
VERSOS.AI**

